

Cathodic Protection Magnetic Assembly Instructions (p/n 40-7202-00)

STEP 1

Remove Handle (B) from Mold (A) by removing 1/4"-20 Hex Nuts (D)

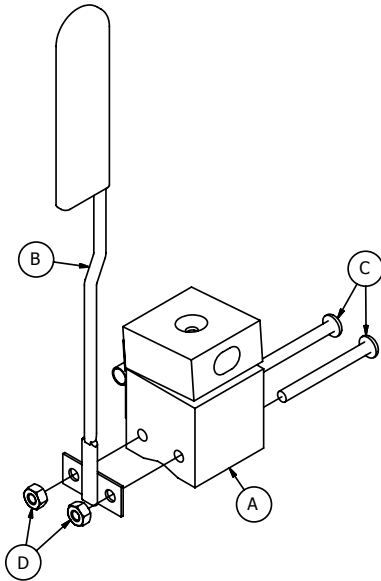

STEP 2

Attach Magnet Assembly (G) to Mold (A) using existing 1/4"-20 Hex Nuts (D) and 1/4"-20 x 2 1/2" lg Machine Screws (C)

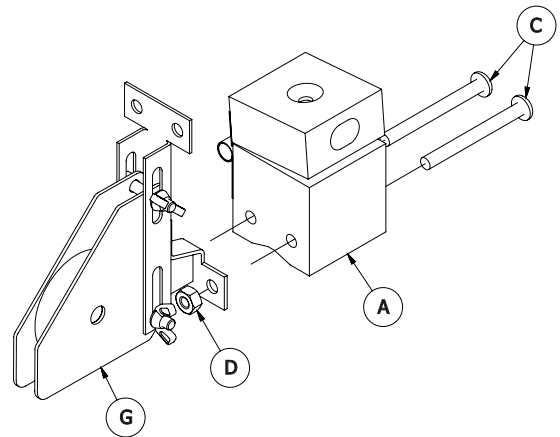

STEP 3

Remove 1/4"-20 Hex Nuts (E) & 1/4"-20 x 1/2" lg Machine Screws (F) from Magnet Assembly (G)

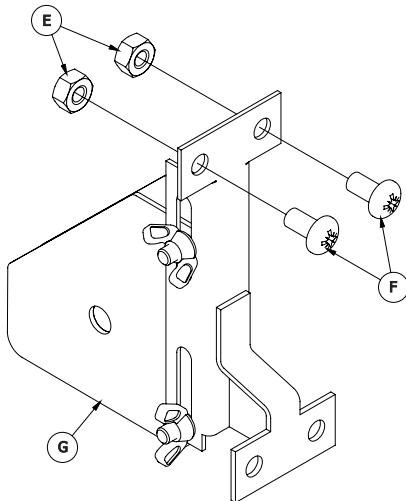

STEP 4

Attach Handle (B) to Magnet Assembly (G) using 1/4"-20 Hex Nuts (E) and 1/4"-20 x 1/2" lg Machine Screws (F).

